

Assembly Notes: Norix is not responsible for any damage due to improper installation. If your shipment does not match the parts list, please contact Norix Customer Service at 800-234-4900. Norix reserves the right to modify design specifications at any time without an obligation to owners of previously sold products.

Parts List				Tools Needed
ITEM	QTY.	PART NUMBER	DESCRIPTION	Low RPM Variable Speed Drill
A	1	071-002	Pin in Torx Bit, T-40	
B	1	027-063-XXX	Forte, Cover Plate, Upholstery	
C	4	027-061	Bracket, Upholstery	
D	1	007-FC610-XXX	Forte, Plywood Shell, Guest Armless Chair	
E	1	021-127-XXX	Screw, Machine 5/16"-18 X .75" FH, T40, Steel	
F	1	FC610-XXX	Forte, Guest Armless Chair	

**Step 1:** Remove the Screw and Plate behind the chair.

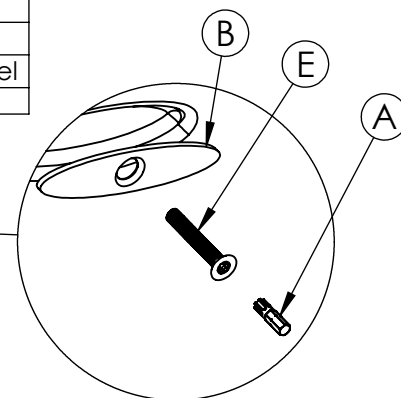
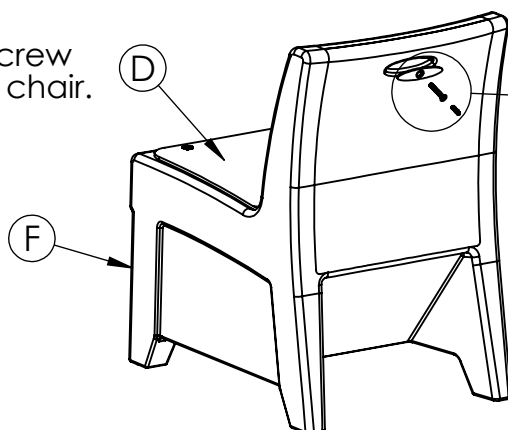

DETAIL A

**Step 2:** Slide the upholstered shell upward and to the rear. Pull the coupler out of the center hole located on top of the seat back.

**Step 3:** Continue sliding the upholstered shell up. The clips on the upholstered shell (Detail B) will disengage from the chair.

3. Slide the bottom out of holes in an upward direction.

1. Pull coupler out of plastic seat. Coupler must remain attached to the upholstered shell.

2. Slide top brackets out of holes in an upward direction.

Brackets from the upholstered shell are joined to corresponding holes in the plastic chair.

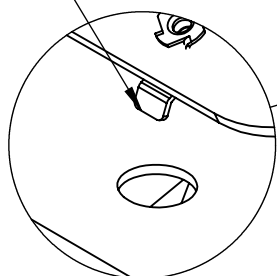
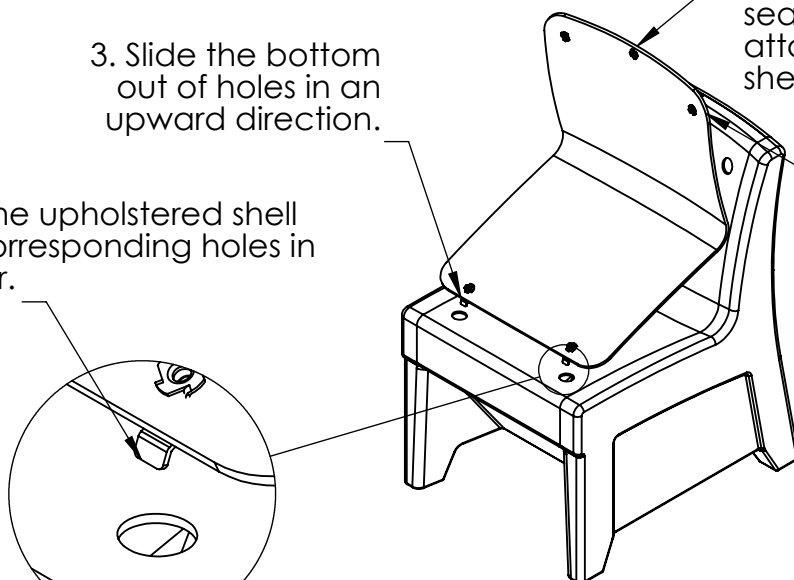

DETAIL B